

Geo Quilt Wall Hanging

Take (2) fabric A 5" x 5" squares and fold in half wrong sides together. Press to create a crease.

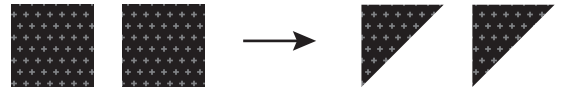

Materials: Natural Collection



Fabric A
Natural Crosses
- Black



Fabric B
Natural Crosses
- Tea Dyed



Fabric C
Natural Crosses
- Natural



Fabric D
Natural Crosses
- White

Fabric Requirements

Fabric A Natural Crosses - Black	0.7m ^{*Includes Binding}
Fabric B Natural Crosses - Tea Dyed	0.5m
Fabric C Natural Crosses - Natural	0.2m
Fabric D Natural Crosses - White	0.2m

Backing

Fabric B Natural Crosses - Tea Dyed **Included**

Binding

Fabric A Natural Crosses - Black **Included**

Please read instructions carefully before cutting

Cutting Instructions

Please note: All strips are cut across the width of fabric (WOF) from selvedge to selvedge unless otherwise noted.

From Fabric A cut:

- (3) 1" x WOF strips. Sub cut:
 - (9) 1" x 7¹/₂" Rectangles
 - (1) 1" x 17¹/₂" Rectangle
- (1) 1³/₄" x WOF strips. Sub cut:
 - (2) 1³/₄" x 17¹/₂" Rectangle
- (2) 4¹/₂" x WOF strips. Sub cut:
 - (1) 4¹/₂" x 17¹/₂" Rectangle
 - (2) 4¹/₂" x 10" Rectangles
 - (2) 4¹/₂" x 5¹/₂" Rectangles
 - (2) 4¹/₂" x 1" Rectangles
- (1) 5" x WOF strips. Sub cut:
 - (6) 5" x 5" Squares

From Fabric B, C & D cut:

- (1) 1¹/₄" x WOF strips. Sub cut:
 - (4) 1¹/₄" x 7¹/₂" Rectangles

Flying Geese Assembly - Seam Allowance: 1/4"

Line up (3) 1" x 7¹/₂" fabric A rectangles and (4) 1¹/₄" x 7¹/₂" fabric B rectangles in alternating order.



Sew together and trim to 4¹/₂" x 7¹/₂"



Line (1) 5" x 5" square up with the 4¹/₂" x 7¹/₂" rectangle.

The crease should be going from the bottom corner to the top middle of the rectangle.



Stitch along crease line, trim excess fabric and press open.

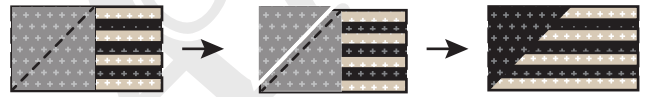

Use the remaining (1) 5" x 5" square, and repeat the previous steps on the opposite end of the 4¹/₂" x 7¹/₂" rectangle.



Repeat with fabric C & D for a total of:

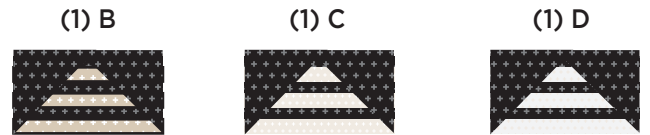

Row Assembly

Row 1



Row 2

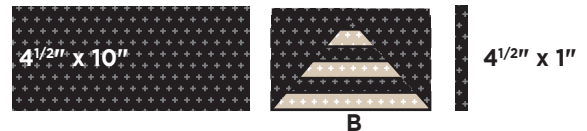

Row 3



Row 4

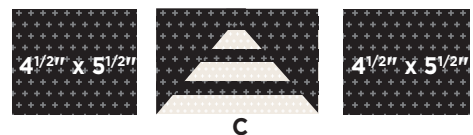

Row 5



Row 6



Row 7



Geo Quilt Wall Hanging

Quilt Layout

Quilt Top Layout

*Follow Quilt Layout while assembling quilt top.

- Use Quilt Layout for row location.
- Sew rows together to create quilt top.
- Layer and quilt as desired.
- Trim hanging to 17" x 19"
- Bind as desired.

Row 1

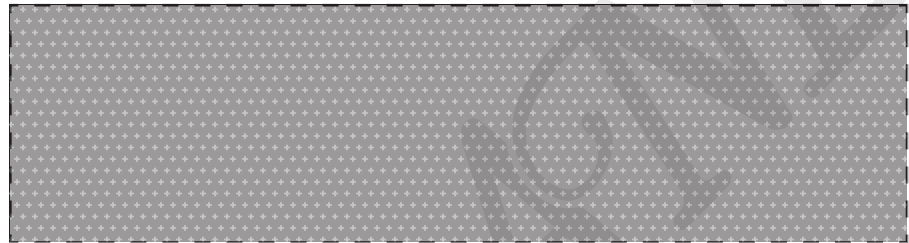

Row 2



Row 3



Row 4

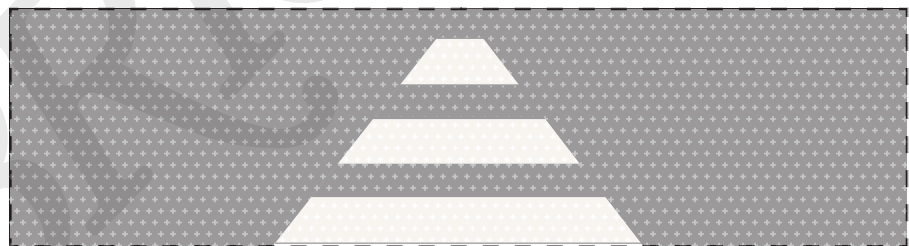

Row 5



Row 6



Row 7



Finished Quilt size: 17" x 19"

For more detailed instructions visit our blog.

©Fabricland 2021.

Every effort has been made to ensure that all projects are error free. As we have no control over the execution of instructions no warranty can be given, nor results guaranteed. This pattern is not available for commercial resale. You cannot copy and sell or digitally distribute this pattern. You may sell items you make with this pattern.